



CONTACTOR, AC-3, 4KW/400V, 1NO,
AC 230V 50/60HZ, 3-POLE, SIZE S00,
SCREW TERMINAL

General technical data:

product brand name		SIRIUS
Size of the contactor		S00
Protection class IP / on the front		IP20
Degree of pollution		3
Installation altitude / at a height over sea level / maximum	m	2,000
Ambient temperature / during operating	°C	-25 ... +60
Mechanical operating cycles as operating time		
<ul style="list-style-type: none"> • of the contactor / typical 		30,000,000
<ul style="list-style-type: none"> • of the contactor with added auxiliary switch block / typical 		10,000,000
<ul style="list-style-type: none"> • of the contactor with added electronics-compatible auxiliary switch block / typical 		5,000,000

Main circuit:

Number of NC contacts / for main contacts		0
Number of NO contacts / for main contacts		3
Operating current		
<ul style="list-style-type: none"> • at AC-3 / at 400 V / rated value 	A	9
<ul style="list-style-type: none"> • at AC-4 / at 400 V / rated value 	A	8.5
<ul style="list-style-type: none"> • with 1 current path / at DC-1 • at 24 V / rated value 	A	20

<ul style="list-style-type: none"> • at 110 V / rated value 	A	2.1
<ul style="list-style-type: none"> • with 2 current paths in series / at DC-1 		
<ul style="list-style-type: none"> • at 24 V / rated value 	A	20
<ul style="list-style-type: none"> • at 110 V / rated value 	A	12
<ul style="list-style-type: none"> • with 3 current paths in series / at DC-1 		
<ul style="list-style-type: none"> • at 24 V / rated value 	A	20
<ul style="list-style-type: none"> • at 110 V / rated value 	A	20
<ul style="list-style-type: none"> • with 1 current path / at DC-3 / at DC-5 		
<ul style="list-style-type: none"> • at 24 V / rated value 	A	20
<ul style="list-style-type: none"> • at 110 V / rated value 	A	0.15
<ul style="list-style-type: none"> • with 2 current paths in series / at DC-3 / at DC-5 		
<ul style="list-style-type: none"> • at 24 V / rated value 	A	20
<ul style="list-style-type: none"> • at 110 V / rated value 	A	0.35
<ul style="list-style-type: none"> • with 3 current paths in series / at DC-3 / at DC-5 		
<ul style="list-style-type: none"> • at 24 V / rated value 	A	20
<ul style="list-style-type: none"> • at 110 V / rated value 	A	20
Service power		
<ul style="list-style-type: none"> • at AC-2 / at 400 V / rated value 	kW	4
<ul style="list-style-type: none"> • at AC-3 / at 400 V / rated value 	kW	4
<ul style="list-style-type: none"> • at AC-4 / at 400 V / rated value 	W	4,000

Control circuit:		
Type of voltage / of the controlled supply voltage		AC
Operating range factor control supply voltage rated value / of the magnet coil		
<ul style="list-style-type: none"> • at 50 Hz • for AC 		0.8 ... 1.1
<ul style="list-style-type: none"> • at 60 Hz • for AC 		0.85 ... 1.1
Apparent pull-in power / of the solenoid / for AC	V·A	27
Apparent holding power / of the solenoid / for AC	V·A	4.4
Inductive power factor / with the pull-in power of the coil		0.8
Inductive power factor / with the pull-in power of the coil		0.27

Auxiliary circuit:		
Contact reliability / of the auxiliary contacts		1 faulty switching per 100 million (17 V, 1 mA)
Number of NC contacts / for auxiliary contacts / instantaneous switching		0
Number of NO contacts / for auxiliary contacts / instantaneous switching		1

Short-circuit:

Design of the fuse link	• for short-circuit protection of the auxiliary switch / required	fuse gL/gG: 10 A
	• for short-circuit protection of the main circuit	fuse gL/gG: 35 A
	• with type of assignment 1 / required	fuse gL/gG: 20 A
	• at type of coordination 2 / required	

Installation/mounting/dimensions:

Type of mounting		screw and snap-on mounting onto 35 mm standard mounting rail according to DIN EN 50022
series installation		Yes
Width	mm	45
Height	mm	57.5
Depth	mm	72
Distance, to be maintained, to earthed part / sideways	mm	6

Connection type:

Design of the electrical connection	• for main current circuit	screw-type terminals
	• for auxiliary and control current circuit	screw-type terminals
Type of the connectable conductor cross-section	• for main contacts	
	• solid	2x (0.5 ... 1.5 mm ²), 2x (0.75 ... 2.5 mm ²), max. 2x (0.75 ... 4 mm ²)
	• finely stranded	
	• with conductor end processing	2x (0.5 ... 1.5 mm ²), 2x (0.75 ... 2.5 mm ²)
	• for AWG conductors / for main contacts	2x (20 ... 16), 2x (18 ... 14), 1x 12
	• for auxiliary contacts	
• solid	2x (0.5 ... 1.5 mm ²), 2x (0.75 ... 2.5 mm ²), max. 2x (0.75 ... 4 mm ²)	
• finely stranded		
• with conductor end processing	2x (0.5 ... 1.5 mm ²), 2x (0.75 ... 2.5 mm ²)	
• for AWG conductors / for auxiliary contacts	2x (20 ... 16), 2x (18 ... 14), 1x 12	

Certificates/approvals:

General Product Approval



Functional Safety /
Safety of
Machinery

Declaration of
Conformity

Test Certificates

[Type Examination](#)



EG-Konf.

[Special Test
Certificate](#)

Shipping Approval



Shipping Approval

other



RMRS

[Confirmation](#)

[other](#)

[Environmental
Confirmations](#)

Further information:

Information- and Downloadcenter (Catalogs, Brochures,...)

<http://www.siemens.com/industrial-controls/catalogs>

Industry Mall (Online ordering system)

<http://www.siemens.com/industrial-controls/mall>

Cax online generator:

<http://www.siemens.com/cax>

Service&Support (Manuals, Certificates, Characteristics, FAQs,...)

<http://support.automation.siemens.com/WWW/view/en/3RT1016-1AP01/all>

Image database (product images, 2D dimension drawings, 3D models, device circuit diagrams, ...)

http://www.automation.siemens.com/bilddb/cax_en.aspx?mlfb=3RT1016-1AP01

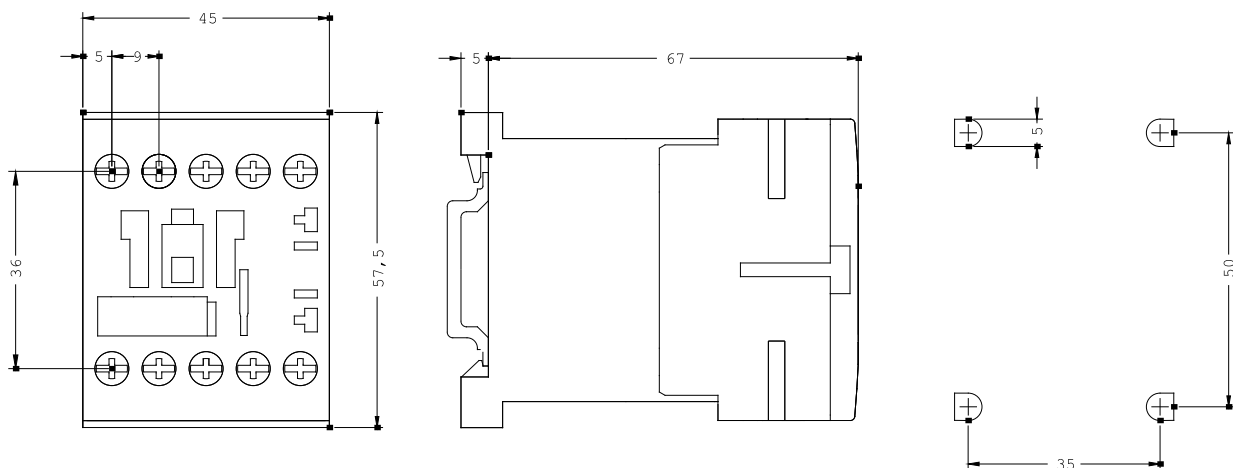

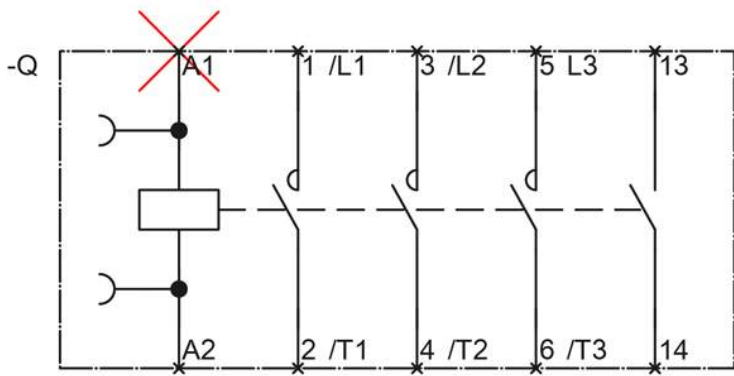

last change:

Feb 24, 2014